



# TABLE LEG SOFA LEG & OTHERS

桌脚·沙发脚·配件系列



鹏盛国际五金有限公司

SINODOM INTERNATIONAL HARDWARE LIMITED

广东纷兰智能家居有限公司

GUANGDONG FINE LINE INTELLIGENT HOUSEHOLD CO.,LTD

地址:广州市番禺区洛浦街南桂路3号恒达产业园B1栋501室

Add:Room 501,Building B1,No.3 Nangui Road,Luopu Street,Panyu District,Guangzhou china

Tel:+86-20-83600848 Fax:+86-20-83600846

Email: sales@sinodom.net / export@sinodom.net

Website: www.sinodom.com



公众号

我们更专业

We are more professional

# TABLE LEGS SERIES

## 台脚系列

### TABLE LEG SERIES | 台脚系列

#### B1859

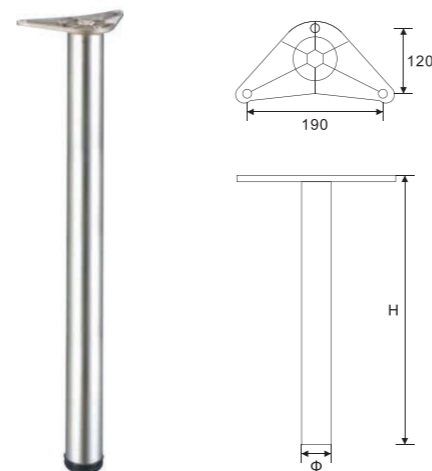

Description/描述:	Table legs 台脚
Material/材质:	Iron 铁
Size/尺寸:	$\varnothing 50 \times H(710/810/910/1100)$ mm $\varnothing 60 \times H(710/810/910/1100)$ mm $\varnothing 76 \times H(710/810/910/1100)$ mm
Finish/表面处理:	拉丝封油、光铬、哑黑、白色、闪光银、闪光金、珍珠镍 BSN/Chrome/Matt black/White/Flash silver/ Flash gold/Pearl nickel
Material thckness/材料厚度:	0.8/1.0mm
Accessories/配件:	三角合金底座, 可调胶座 Trianglar alloy plate/Adjustable stopper
The height can be customized / 高度可定做	

#### B1859

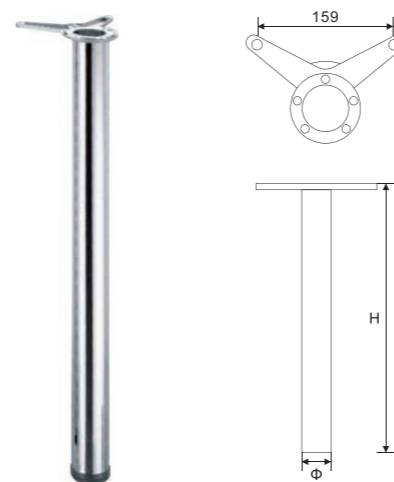

Description/描述:	Table legs 台脚
Material/材质:	Iron 铁
Size/尺寸:	$\varnothing 50 \times H(710/810/910/1100)$ mm $\varnothing 60 \times H(710/810/910/1100)$ mm
Finish/表面处理:	拉丝封油、光铬、哑黑、白色、闪光银、闪光金、珍珠镍 BSN/Chrome/Matt black/White/Flash silver/ Flash gold/Pearl nickel
Material thckness/材料厚度:	0.8/1.0mm
Accessories/配件:	鱼尾合金底座, 六角匙1条, 可调胶座 "V"shape alloy plate/Allan key/Adjustable stopper
The height can be customized / 高度可定做	

#### B1859

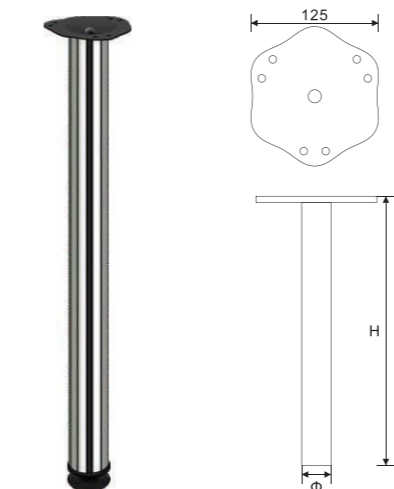

Description/描述:	Table legs 台脚
Material/材质:	Iron 铁
Size/尺寸:	$\varnothing 50 \times H(710/810/910/1100)$ mm $\varnothing 60 \times H(710/810/910/1100)$ mm
Finish/表面处理:	拉丝封油、光铬、哑黑、白色、闪光银、闪光金、珍珠镍 BSN/Chrome/Matt black/White/Flash silver/ Flash gold/Pearl nickel
Material thckness/材料厚度:	0.8/1.0mm
Accessories/配件:	九边形铁底座, 可调胶座 Nonagon steel plate/Adjustable stopper
The height can be customized / 高度可定做	



B1859

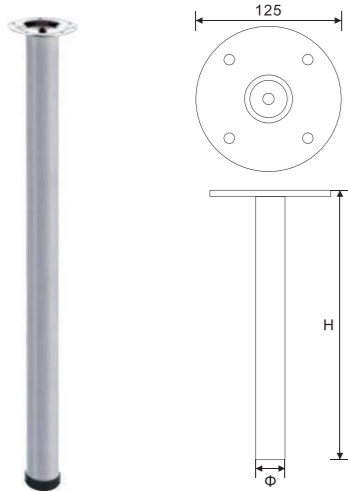

Description/描述:	Table legs 台脚
Material/材质:	Iron 铁
Size/尺寸:	∅ 50×H(710/810/910/1100)mm ∅ 60×H(710/810/910/1100)mm
Finish/表面处理:	拉丝封油、光铬、哑黑、白色、闪光银、闪光金、珍珠镍 BSN/Chrome/Matt black/White/Flash silver/ Flash gold/Pearl nickel
Material thckness/材料厚度:	0.8/1.0mm
Accessories/配件:	圆形铁片, 可调胶座 Round iron sheet/Adjustable stopper
The height can be customized / 高度可定做	

B1859

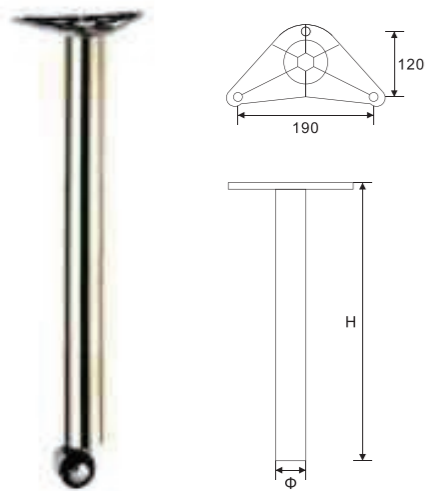

Description/描述:	Table legs 台脚
Material/材质:	Iron 铁
Size/尺寸:	∅ 50×H(710/810/910/1100)mm ∅ 60×H(710/810/910/1100)mm
Finish/表面处理:	拉丝封油、光铬、哑黑、白色、闪光银、闪光金、珍珠镍 BSN/Chrome/Matt black/White/Flash silver/ Flash gold/Pearl nickel
Material thckness/材料厚度:	0.8/1.0mm
Accessories/配件:	三角合金底座, 可调胶座 Trianglar alloy plate/Adjustable stopper
The height can be customized / 高度可定做	

B1859

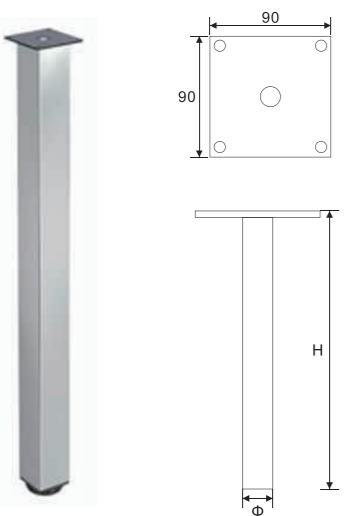

Description/描述:	Table legs 台脚
Material/材质:	Iron 铁
Size/尺寸:	(60×60)×H(710/810/910/1100)mm
Finish/表面处理:	拉丝封油、光铬、哑黑、白色、闪光银、闪光金、珍珠镍 BSN/Chrome/Matt black/White/Flash silver/ Flash gold/Pearl nickel
Material thckness/材料厚度:	1.0/1.2mm
Accessories/配件:	正方形铁底座, 可调胶座 Square iron base/Adjustable stopper
The height can be customized / 高度可定做	

B1859

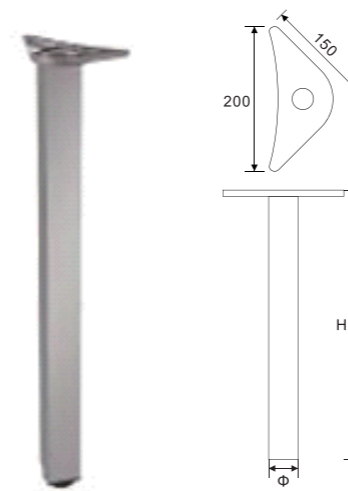

Description/描述:	Table legs 台脚
Material/材质:	Iron 铁
Size/尺寸:	(60×60)×H(710/810/910/1100)mm
Finish/表面处理:	拉丝封油、光铬、哑黑、白色、闪光银、闪光金、珍珠镍 BSN/Chrome/Matt black/White/Flash silver/ Flash gold/Pearl nickel
Material thckness/材料厚度:	1.0/1.2mm
Accessories/配件:	三角合金座, 六角匙1条, 可调胶座 Trianglar alloy plat/Adjustable stopper
The height can be customized / 高度可定做	

B1859

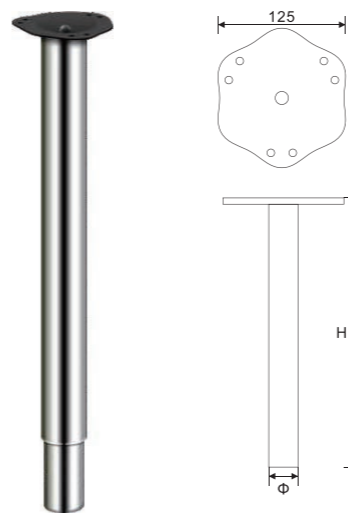

Description/描述:	Table legs 台脚
Material/材质:	Iron 铁
Size/尺寸:	∅ 50×H(710/810/910/1100)mm ∅ 60×H(710/810/910/1100)mm
Finish/表面处理:	拉丝封油、光铬、哑黑、白色、闪光银、闪光金、珍珠镍 BSN/Chrome/Matt black/White/Flash silver/ Flash gold/Pearl nickel
Material thckness/材料厚度:	0.8/1.0mm
Accessories/配件:	九边形铁底座, 可调胶座 Nonagon steel plate/Adjustable stopper
The height can be customized / 高度可定做	

B1859

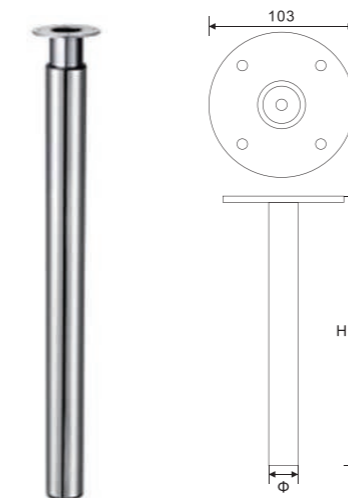

Description/描述:	Table legs 台脚
Material/材质:	Iron 铁
Size/尺寸:	∅ 50×H(710/810/910/1100)mm ∅ 60×H(710/810/910/1100)mm
Finish/表面处理:	拉丝封油、光铬、哑黑、白色、闪光银、闪光金、珍珠镍 BSN/Chrome/Matt black/White/Flash silver/ Flash gold/Pearl nickel
Material thckness/材料厚度:	0.8/1.0mm
Accessories/配件:	圆形铁片 Round iron shee
The height can be customized / 高度可定做	

# SOFA LEG SERIES

## 沙发脚系列

### SOFA LEG SERIES | 沙发脚系列



#### B1037~38

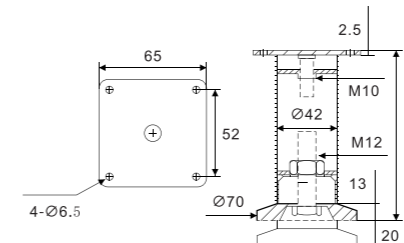

Description/描述: Adjustable Leg 可调脚  
 Material/材质: Iron 铁  
 Size/尺寸: Ø-42mm  
 H-80/100/120/150/180/200mm  
 Finish/表面处理: 光铬、拉丝、哑黑、白色、闪光银  
 Chrome/BSN/Matt black/White/Flash silver  
 The height can be customized/高度可定做

#### B1037~38

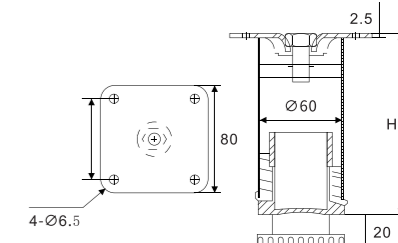

Description/描述: Adjustable Leg 可调脚  
 Material/材质: Iron 铁  
 Size/尺寸: Ø-60mm  
 H-80/100/120/150/180/200mm  
 Finish/表面处理: 光铬、拉丝、哑黑、白色、闪光银  
 Chrome/BSN/Matt black/White/Flash silver  
 The height can be customized/高度可定做

#### B1037~38

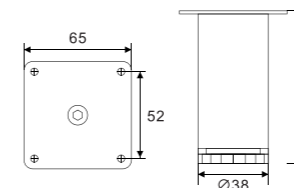

Description/描述: Adjustable Leg 可调脚  
 Material/材质: Iron 铁  
 Size/尺寸: Ø-38mm  
 H-80/100/120/200/250/300mm  
 Finish/表面处理: 光铬、拉丝、哑黑、白色、闪光银  
 Chrome/BSN/Matt black/White/Flash silver  
 The height can be customized/高度可定做

#### B1037~38

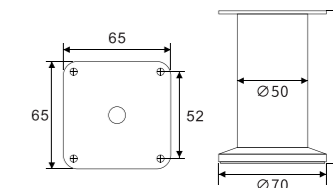

Description/描述: Adjustable Leg 可调脚  
 Material/材质: Iron 铁  
 Size/尺寸: Ø-50mm  
 H-80/100/120/200/250/300mm  
 Finish/表面处理: 光铬、拉丝、哑黑、白色、闪光银  
 Chrome/BSN/Matt black/White/Flash silver  
 The height can be customized/高度可定做

#### B1037~38

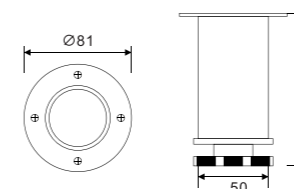

Description/描述: Adjustable Leg 可调脚  
 Material/材质: Iron 铁/Stainless steel 不锈钢  
 Size/尺寸: Ø-50/60mm  
 H-80/100/120/150/200/250/300mm  
 Finish/表面处理: 光铬、拉丝、哑黑、白色、闪光银  
 Chrome/BSN/Matt black/White/Flash silver  
 The height can be customized/高度可定做

#### B1037~38

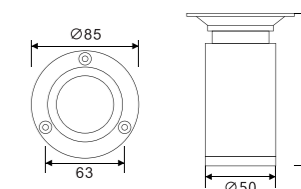

Description/描述: Adjustable Leg 可调脚  
 Material/材质: Iron 铁/Stainless steel 不锈钢  
 Size/尺寸: Ø-50/60mm  
 H-80/100/120/150/200/250/300mm  
 Finish/表面处理: 光铬、拉丝、哑黑、白色、闪光银  
 Chrome/BSN/Matt black/White/Flash silver  
 The height can be customized/高度可定做



**B1037~38**

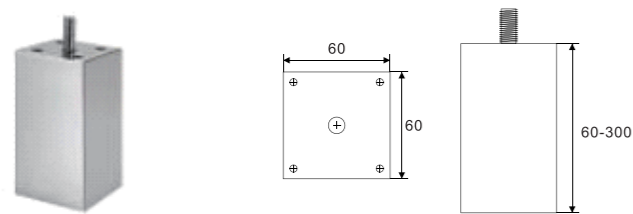

Description/描述: Sofa Leg 沙发脚  
 Material/材质: Iron 铁  
 Size/尺寸:  $\varnothing$ -60×60mm  
 H-60/80/100/120/150/200mm  
 Finish/表面处理: 光铬、拉丝、哑黑、白色、闪光银  
 Chrome/BSN/Matt black/White/Flash silver  
 The height can be customized/高度可定做

**B1037~38**

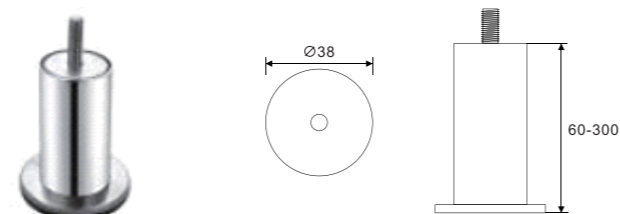

Description/描述: Sofa Leg 沙发脚  
 Material/材质: Stainless steel 不锈钢  
 Size/尺寸:  $\varnothing$ -38mm  
 H-60/80/100/120/150/180/200mm  
 Finish/表面处理: 光铬、拉丝  
 Chrome/BSN  
 The height can be customized/高度可定做

**B1037~38**

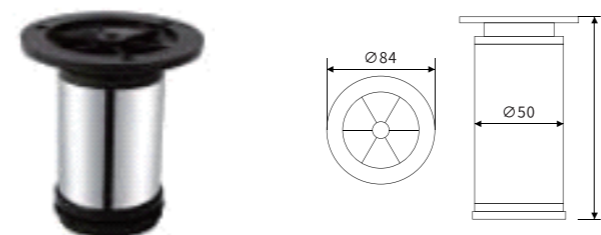

Description/描述: Adjustable Leg 可调脚  
 Material/材质: Stainless steel 不锈钢/Aluminum alloys 铝合金  
 Size/尺寸:  $\varnothing$ -50mm  
 H-80/100/120/150/180/200mm  
 Finish/表面处理: 光铬、拉丝、喷砂、哑光  
 Chrome/BSN/Sand sprayed/Cloudy color  
 The height can be customized/高度可定做

**B1037~38**



Description/描述: Adjustable Leg 可调脚  
 Material/材质: Iron 铁/Stainless steel 不锈钢/Aluminum alloys 铝合金  
 Size/尺寸:  $\varnothing$ -40×40mm  
 H-80/100/120/150/180/200mm  
 Finish/表面处理: 光铬、拉丝、喷砂、哑光  
 Chrome/BSN/Sand sprayed/Cloudy color  
 The height can be customized/高度可定做

**B1037~38**

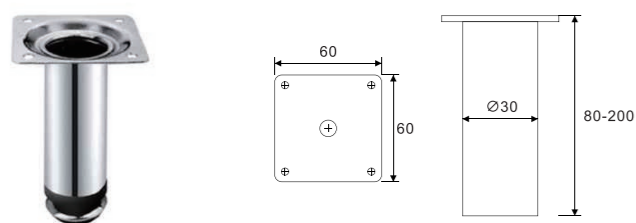

Description/描述: Furniture Leg 家具脚  
 Material/材质: Iron 铁  
 Size/尺寸:  $\varnothing$ -30mm  
 H-80/100/120/150/200mm  
 Finish/表面处理: 光铬、拉丝、哑黑、白色、闪光银  
 Chrome/BSN/Matt black/White/Flash silver  
 The height can be customized/高度可定做

**B1037~38**

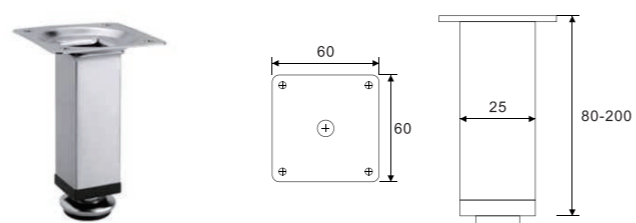

Description/描述: Adjustable Leg 可调脚  
 Material/材质: Iron 铁/Stainless steel 不锈钢  
 Size/尺寸:  $\varnothing$ -25×25mm  
 H-80/100/120/150/180/200mm  
 Finish/表面处理: 光铬、拉丝、哑黑、白色、闪光银  
 Chrome/BSN/Matt black/White/Flash silver  
 The height can be customized/高度可定做

**B1037~38**

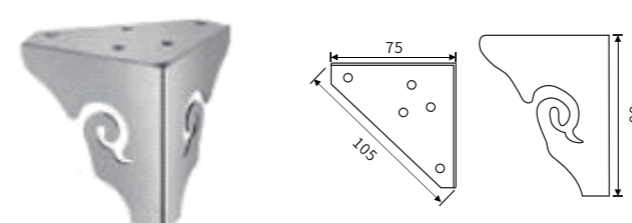

Description/描述: Unadjustable Leg 不可调脚  
 Material/材质: Iron 铁  
 Size/尺寸: H-90/130mm  
 Finish/表面处理: 光铬、拉丝、哑黑、白色、闪光银  
 Chrome/BSN/Matt black/White/Flash silver  
 The height can be customized/高度可定做

**B1037~38**

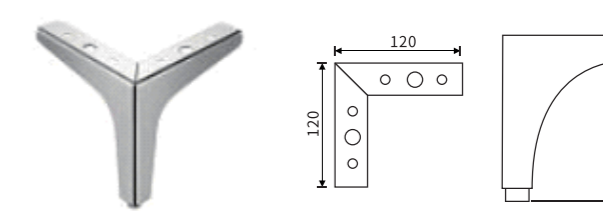

Description/描述: Unadjustable Leg 不可调脚  
 Material/材质: Iron 铁  
 Size/尺寸: H-130mm  
 Finish/表面处理: 光铬、拉丝、哑黑、白色、闪光银  
 Chrome/BSN/Matt black/White/Flash silver  
 The height can be customized/高度可定做

**B1037~38**

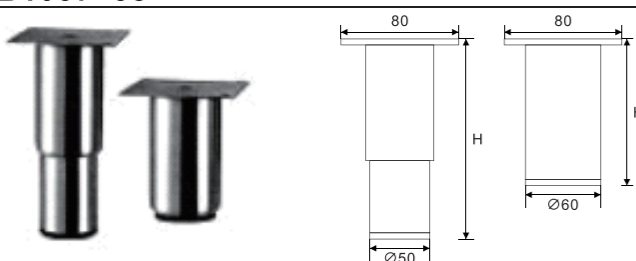

Description/描述: Lift foot 升降脚  
 Material/材质: Iron 铁/Stainless steel 不锈钢  
 Size/尺寸:  $\varnothing$ -50/60mm  
 H-100/150mm  
 Finish/表面处理: 光铬、拉丝、哑黑、白色、闪光银  
 Chrome/BSN/Matt black/White/Flash silver  
 The height can be customized/高度可定做

**B1037~38**

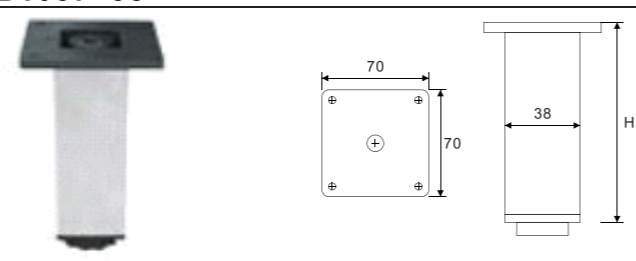

Description/描述: Adjustable Leg 可调脚  
 Material/材质: Stainless steel 不锈钢/Aluminum alloys 铝合金  
 Size/尺寸:  $\varnothing$ -38×38mm  
 H-80/100/120/150/180/200mm  
 Finish/表面处理: 光铬、拉丝、喷砂、哑光  
 Chrome/BSN/Sand sprayed/Cloudy color  
 The height can be customized/高度可定做

**B1037~38**

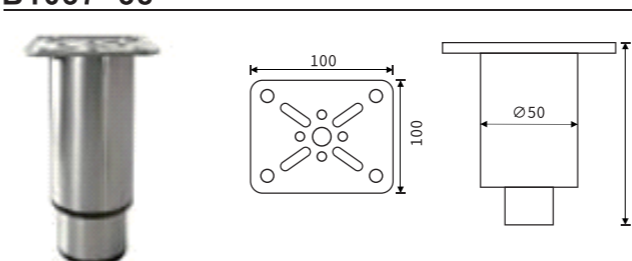

Description/描述: Adjustable Leg 可调脚  
 Material/材质: Iron 铁  
 Size/尺寸:  $\varnothing$ -50mm  
 H-100mm  
 Finish/表面处理: 光铬、拉丝、哑黑、白色、闪光银  
 Chrome/BSN/Matt black/White/Flash silver  
 The height can be customized/高度可定做

**B1037~38**

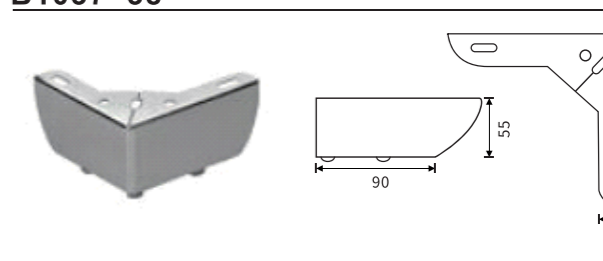

Description/描述: Unadjustable Leg 不可调脚  
 Material/材质: Iron 铁  
 Size/尺寸: H-55mm  
 Finish/表面处理: 光铬、拉丝、闪光银、珍珠镍  
 Chrome/BSN/Flash silver/Pearl nickel  
 The height can be customized/高度可定做

**B1037~38**

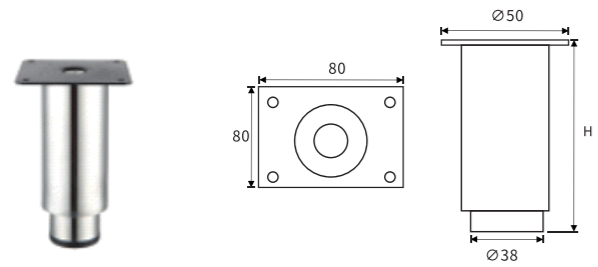

Description/描述: Sofa Leg 沙发脚  
 Material/材质: Iron 铁  
 Size/尺寸:  $\varnothing$ -50mm  
 H-100/120/150mm  
 Finish/表面处理: 光铬、拉丝  
 Chrome/BSN  
 The height can be customized/高度可定做

**B1037~38**

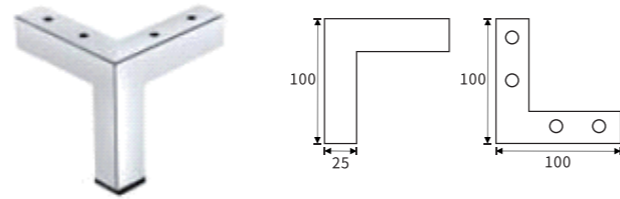

Description/描述: Sofa Leg 沙发脚  
 Material/材质: Iron 铁  
 Size/尺寸: H-100mm  
 Finish/表面处理: 光铬、砂镍、喷砂  
 Chrome/Matt Nickel/Sand sprayed  
 The height can be customized/高度可定做

**B1037~38**

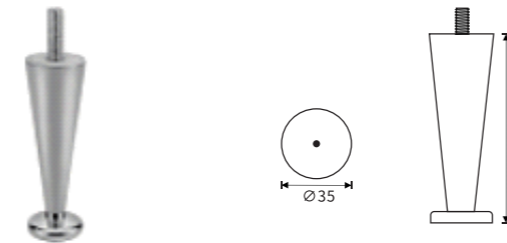

Description/描述: Furniture Leg 家具脚  
 Material/材质: Aluminum alloys 铝合金  
 Size/尺寸:  $\varnothing$ -35mm  
 H-120mm  
 Finish/表面处理: 喷砂、光铬、哑光  
 Sand sprayed/Chrome/Cloudy color  
 The height can be customized/高度可定做  
 Equipped 10mm Screw/可配10毫米螺丝

**B1037~38**

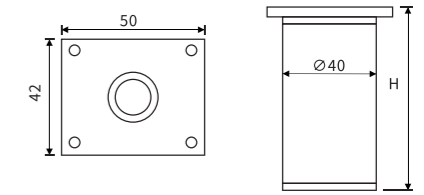

Description/描述: Furniture Leg 家具脚  
 Material/材质: Aluminum alloys 铝合金  
 Size/尺寸:  $\varnothing$ -40mm  
 H-80/100/120/150/200mm  
 Finish/表面处理: 喷砂、光铬、哑光、拉丝  
 Sand sprayed/Chrome/Cloudy color/BSN  
 The height can be customized/高度可定做

**B1037~38**

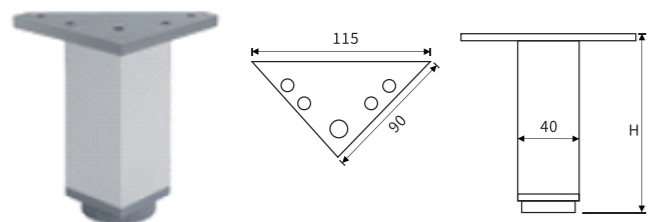

Description/描述: Furniture Leg 家具脚  
 Material/材质: Aluminum alloys 铝合金  
 Size/尺寸:  $\varnothing$ -40\*40mm  
 H-80/100/120/150/200mm  
 Finish/表面处理: 喷砂、光铬、哑光、拉丝  
 Sand sprayed/Chrome/Cloudy color/BSN  
 The height can be customized/高度可定做

**B1037~38**

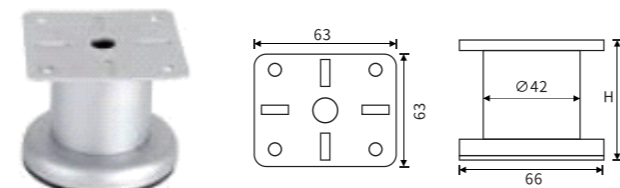

Description/描述: Sofa Leg 沙发脚  
 Material/材质: Iron 铁  
 Size/尺寸:  $\varnothing$ -42mm  
 H-60/80/100/120/150mm  
 Finish/表面处理: 光铬  
 Chrome  
 The height can be customized/高度可定做

**B1037~38**

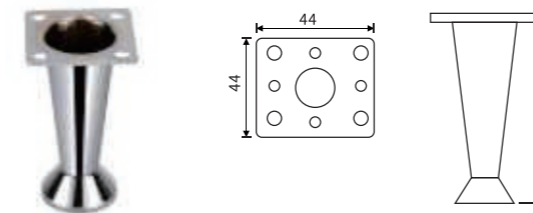

Description/描述: Cabinet Leg 柜脚  
 Material/材质: Zinc alloys 锌合金  
 Size/尺寸: H-50/80/100mm  
 Finish/表面处理: 光铬、拉丝、闪光金、闪光银  
 Chrome/BSN/Flash gold/Flash silver  
 The height can be customized/高度可定做

**B1037~38**

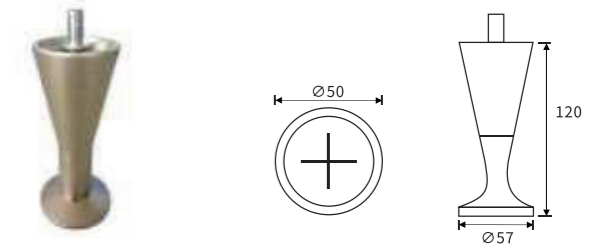

Description/描述: Unadjustable Leg 不可调脚  
 Material/材质: Zinc alloys 锌合金  
 Size/尺寸:  $\varnothing$ -50mm  
 H-100mm  
 Finish/表面处理: 光铬、拉丝、哑黑、白色、闪光银  
 Chrome/BSN/Matt black/White/Flash silver  
 The height can be customized/高度可定做

**B1037~38**

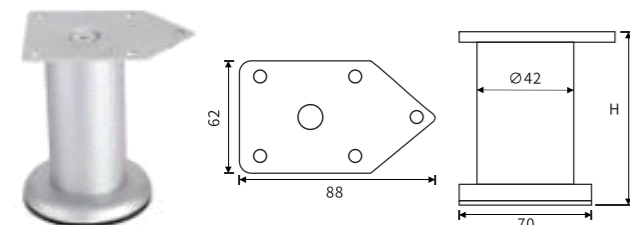

Description/描述: Sofa Leg 沙发脚  
 Material/材质: Iron 铁  
 Size/尺寸:  $\varnothing$ -42mm  
 H-60/80/100/120/150/180/200mm  
 Finish/表面处理: 光铬  
 Chrome  
 The height can be customized/高度可定做

**B1037~38**

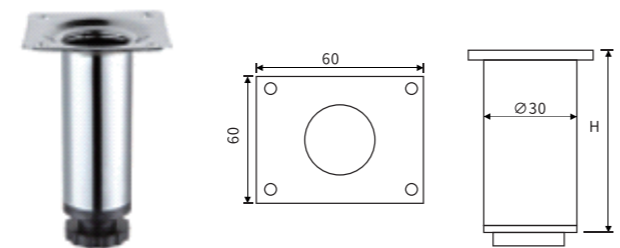

Description/描述: Sofa Leg 沙发脚  
 Material/材质: Iron 铁  
 Size/尺寸:  $\varnothing$ -30mm  
 H-60/80/100/120/150mm  
 Finish/表面处理: 光铬、拉丝  
 Chrome/BSN  
 The height can be customized/高度可定做

**B1037~38**

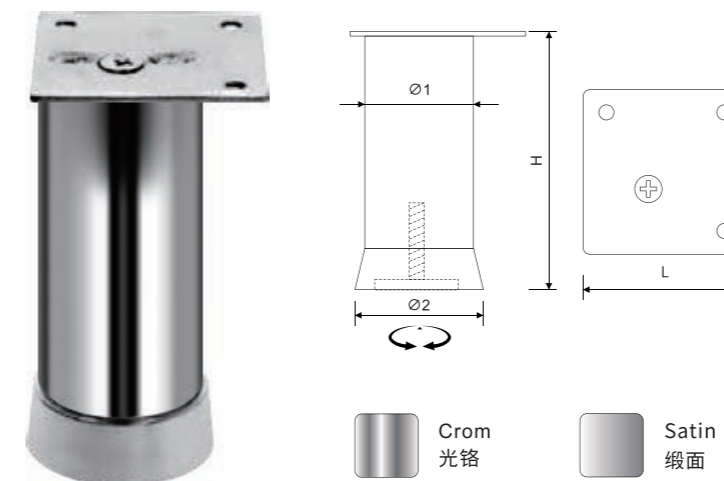

Description/描述: Adjustable Sofa Leg  
 可调节沙发脚  
 Material/材质: Aluminum alloys  
 铝合金  
 Size/尺寸:  $\varnothing$ -40/48mm  
 L-55\*55mm  
 H-80/100/120/150/180/200mm  
 Finish/表面处理: 光铬、镍拉丝、青古铜、  
 亚光黑、哑光白、闪金色  
 Chrome/Nickel brushed/Bronze/  
 Matte black/Matte white/Flash gold  
 The height can be customized/高度可定做

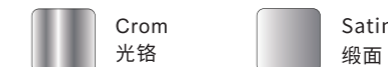



# SOFA LEG SERIES

## 沙发脚系列



### B1037~38

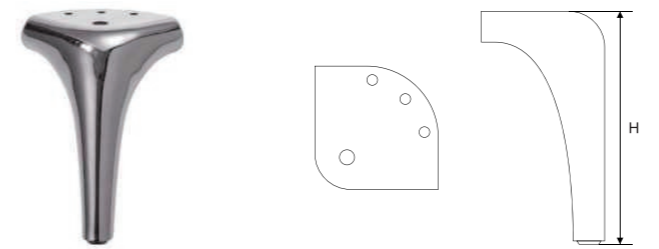

Description/描述: Stamped Sofa Leg 冲压沙发脚  
 Material/材质: Iron 铁  
 Size/尺寸: H-120/150mm  
 Finish/表面处理: 镀铬  
 Chrome plated

### B1037~38

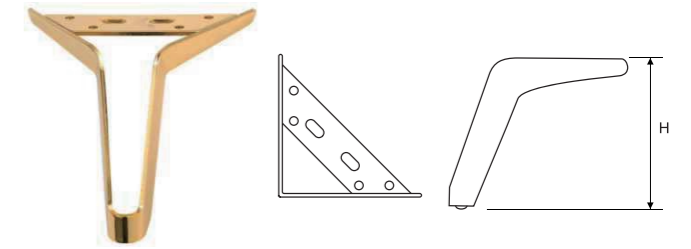

Description/描述: Stamped Sofa Leg 冲压沙发脚  
 Material/材质: Iron 铁  
 Size/尺寸: H-150mm  
 Finish/表面处理: 镀铬  
 Chrome plated

### B1037~38

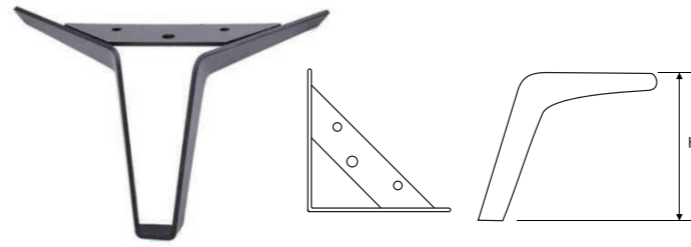

Description/描述: Stamped Sofa Leg 冲压沙发脚  
 Material/材质: Iron 铁  
 Size/尺寸: H-130-200mm  
 Finish/表面处理: 镀铬  
 Chrome plated

### B1037~38

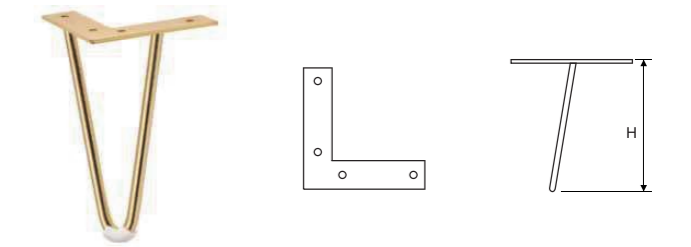

Description/描述: Steel Support Sofa Leg 钢支沙发脚  
 Material/材质: Iron 铁  
 Size/尺寸: H-100-720mm  
 Finish/表面处理: 亮光  
 Polished

### B1037~38

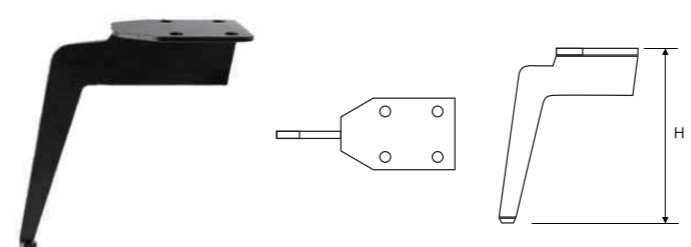

Description/描述: Iron plate Sofa Leg 铁板沙发脚  
 Material/材质: Iron 铁  
 Size/尺寸: H-120-170mm  
 Finish/表面处理: 镀铬  
 Chrome plated

### B1037~38

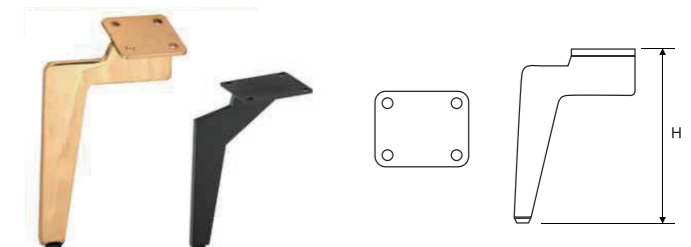

Description/描述: Iron plate Sofa Leg 铁板沙发脚  
 Material/材质: Iron 铁  
 Size/尺寸: H-120-180mm  
 Finish/表面处理: 镀铬  
 Chrome plated



**B1037~38**



Description/描述: Iron plate Sofa Leg 铁板沙发脚  
 Material/材质: Iron 铁  
 Size/尺寸: H-80-120mm  
 Finish/表面处理: 镀铬  
 Chrome plated

**B1037~38**

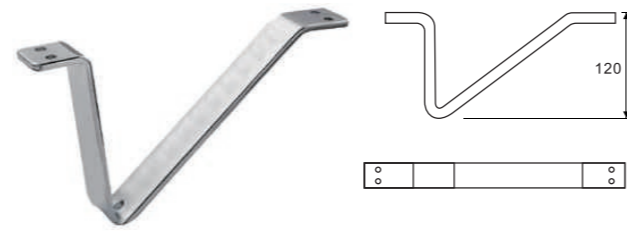

Description/描述: Iron plate Sofa Leg 铁板沙发脚  
 Material/材质: Iron 铁  
 Size/尺寸: H-120mm  
 Finish/表面处理: 镀铬  
 Chrome plated

**B1037~38**

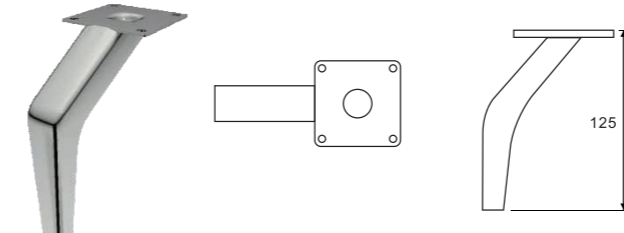

Description/描述: Stamped Sofa Leg 冲压沙发脚  
 Material/材质: Iron 铁  
 Size/尺寸: H-125mm  
 Finish/表面处理: 镀铬  
 Chrome plated

**B1037~38**



Description/描述: Stamped Sofa Leg 冲压沙发脚  
 Material/材质: Iron 铁  
 Size/尺寸: H-100-170mm  
 Finish/表面处理: 镀铬  
 Chrome plated

The height can be customized/高度可定做

**B1037~38**

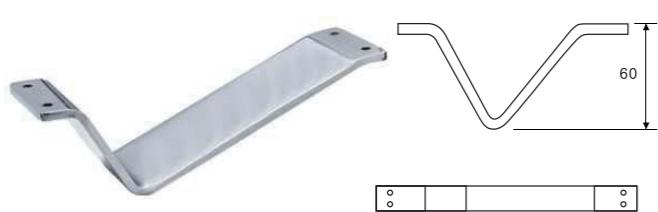

Description/描述: Iron plate Sofa Leg 铁板沙发脚  
 Material/材质: Iron 铁  
 Size/尺寸: H-60mm  
 Finish/表面处理: 镀铬  
 Chrome plated

**B1037~38**



Description/描述: Iron plate Sofa Leg 铁板沙发脚  
 Material/材质: Iron 铁  
 Size/尺寸: H-100-180mm  
 Finish/表面处理: 镀铬  
 Chrome plated

**B1037~38**

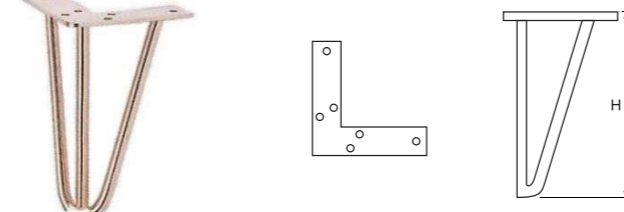

Description/描述: Steel Support Sofa Leg 钢支沙发脚  
 Material/材质: Iron 铁  
 Size/尺寸: H-100-750mm  
 Finish/表面处理: 镀铬  
 Chrome plated

**B1037~38**

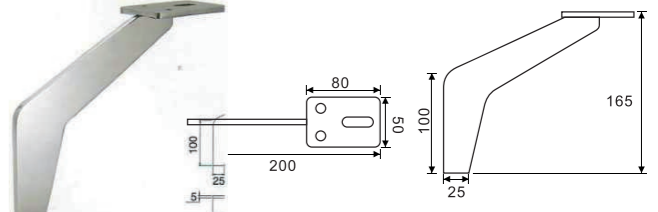

Description/描述: Steel Sofa Leg 不锈钢沙发脚  
 Material/材质: Stainless steel 不锈钢  
 Size/尺寸: H-165mm  
 Finish/表面处理: 亮光  
 Polished

**B1037~38**

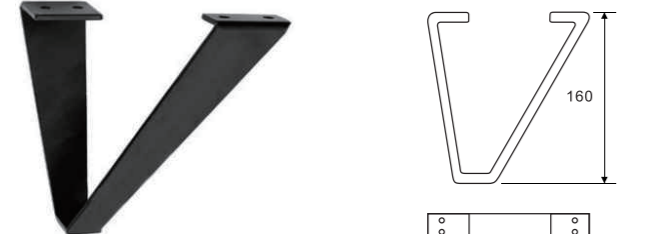

Description/描述: Iron plate Sofa Leg 铁板沙发脚  
 Material/材质: Iron 铁  
 Size/尺寸: H-160mm  
 Finish/表面处理: 镀铬  
 Chrome plated

**B1037~38**



Description/描述: Iron plate Sofa Leg 铁板沙发脚  
 Material/材质: Iron 铁  
 Size/尺寸: H-160mm  
 Finish/表面处理: 镀铬  
 Chrome plated

**B1037~38**

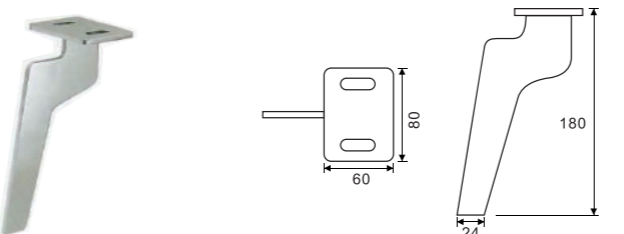

Description/描述: Steel Sofa Leg 不锈钢沙发脚  
 Material/材质: Stainless steel 不锈钢  
 Size/尺寸: H-180mm  
 Finish/表面处理: 亮光  
 Polished

**B1037~38**

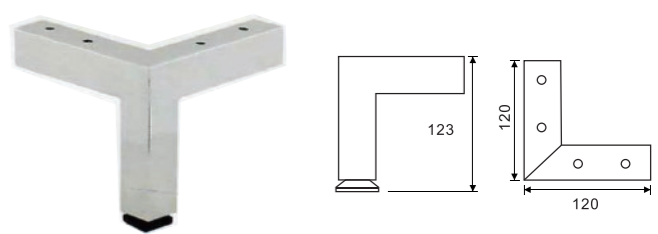

Description/描述: Steel Sofa Leg 不锈钢沙发脚  
 Material/材质: Stainless steel 不锈钢  
 Size/尺寸: H-123mm  
 Finish/表面处理: 亮光  
 Polished



# Harmony and exquisite

A housing style bringing out refined fluency. 和谐·精致

彰显流畅脱俗的家居个性



SOFA LEG SERIES  
沙发脚系列

## B1037~38

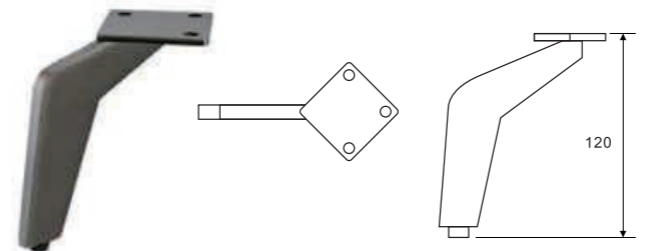

Description/描述: Sofa Leg 沙发脚  
Material/材质: Iron 铁  
Size/尺寸: H-120mm  
Finish/表面处理: Gun black/枪黑

## B1037~38

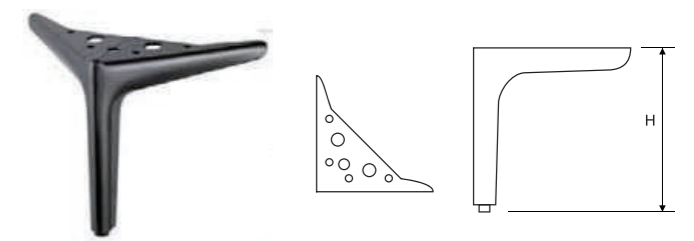

Description/描述: Sofa Leg 沙发脚  
Material/材质: Iron 铁  
Size/尺寸: H-120/150/180mm  
Finish/表面处理: 枪黑、金色、哑黑、光铬  
Gun black/Golden/Matt black/Chrome

## B1037~38

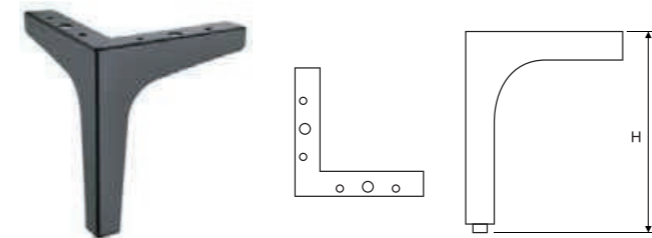

Description/描述: Sofa Leg 沙发脚  
Material/材质: Iron 铁  
Size/尺寸: H-80/100/130/150/170mm  
Finish/表面处理: 枪黑、金色、哑黑、光铬  
Gun black/Golden/Matt black/Chrome

## B1037~38

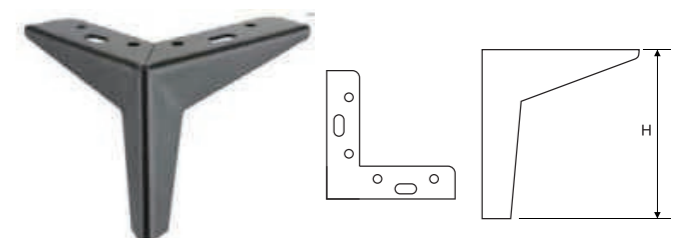

Description/描述: Sofa Leg 沙发脚  
Material/材质: Iron 铁  
Size/尺寸: H-100/130/150/170mm  
Finish/表面处理: 枪黑、金色、哑黑、光铬  
Gun black/Golden/Matt black/Chrome

## B1037~38

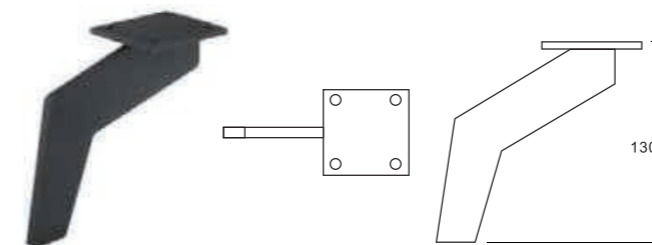

Description/描述: Sofa Leg 沙发脚  
Material/材质: Iron 铁  
Size/尺寸: H-130mm  
Finish/表面处理: 枪黑、金色、哑黑、光铬  
Gun black/Golden/Matt black/Chrome

## B1037~38

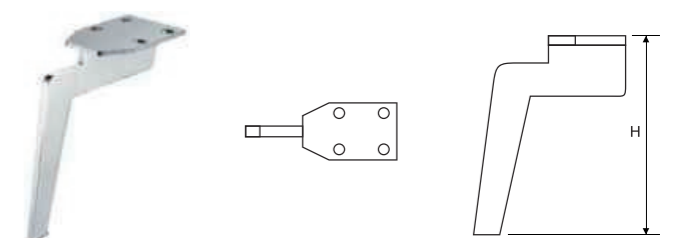

Description/描述: Sofa Leg 沙发脚  
Material/材质: Iron 铁  
Size/尺寸: H-150/170mm  
Finish/表面处理: 枪黑、金色、哑黑、光铬  
Gun black/Golden/Matt black/Chrome



**B1037~38**

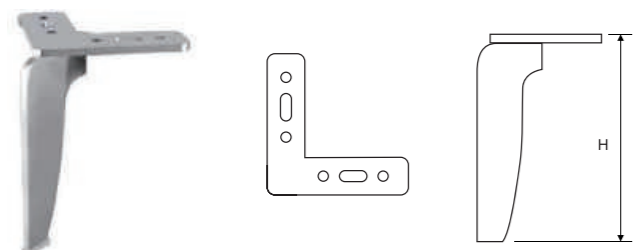

Description/描述: Sofa Leg 沙发脚  
 Material/材质: Iron 铁  
 Size/尺寸: H-120/150mm  
 Finish/表面处理: 枪黑、金色、哑黑、光铬  
 Gun black/Golden/Matt black/Chrome

**B1037~38**

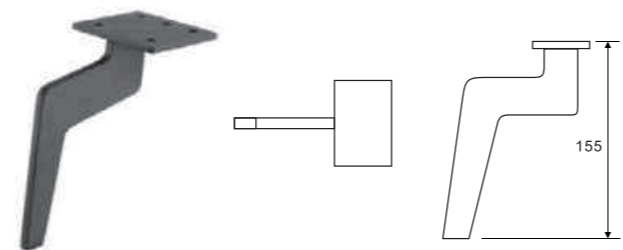

Description/描述: Sofa Leg 沙发脚  
 Material/材质: Iron 铁  
 Size/尺寸: H-155mm  
 Finish/表面处理: 枪黑、金色、哑黑、光铬  
 Gun black/Golden/Matt black/Chrome

**B1037~38**

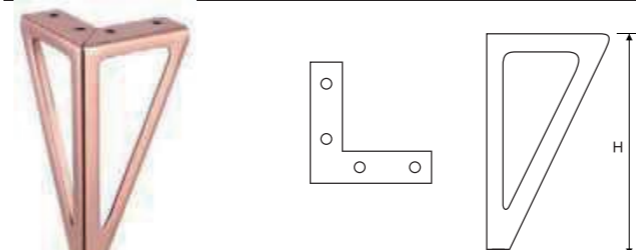

Description/描述: Sofa Leg 沙发脚  
 Material/材质: Iron 铁  
 Size/尺寸: H-130/150mm  
 Finish/表面处理: 枪黑、金色、哑黑、光铬  
 Gun black/Golden/Matt black/Chrome

**B1037~38**

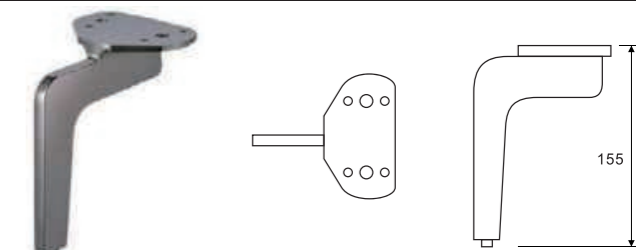

Description/描述: Sofa Leg 沙发脚  
 Material/材质: Iron 铁  
 Size/尺寸: H-155mm  
 Finish/表面处理: 枪黑、金色、哑黑、光铬  
 Gun black/Golden/Matt black/Chrome

**B1037~38**

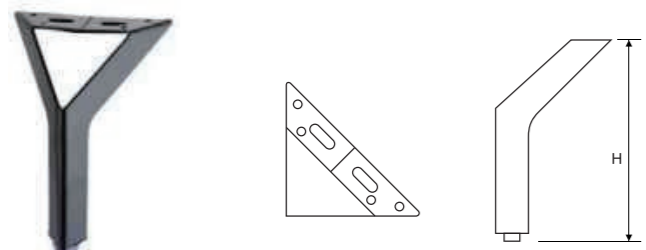

Description/描述: Sofa Leg 沙发脚  
 Material/材质: Iron 铁  
 Size/尺寸: H-120/150mm  
 Finish/表面处理: 枪黑、金色、哑黑、光铬  
 Gun black/Golden/Matt black/Chrome

**B1037~38**

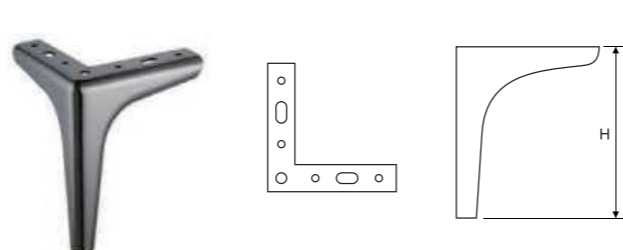

Description/描述: Sofa Leg 沙发脚  
 Material/材质: Iron 铁  
 Size/尺寸: H-130/170/190mm  
 Finish/表面处理: 枪黑、金色、哑黑、光铬  
 Gun black/Golden/Matt black/Chrome

**B1037~38**

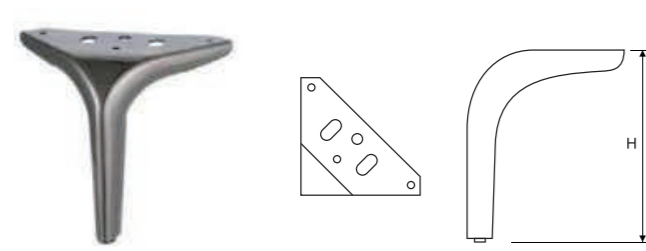

Description/描述: Sofa Leg 沙发脚  
 Material/材质: Iron 铁  
 Size/尺寸: H-120/150/180mm  
 Finish/表面处理: 枪黑、金色、哑黑、光铬  
 Gun black/Golden/Matt black/Chrome

**B1037~38**

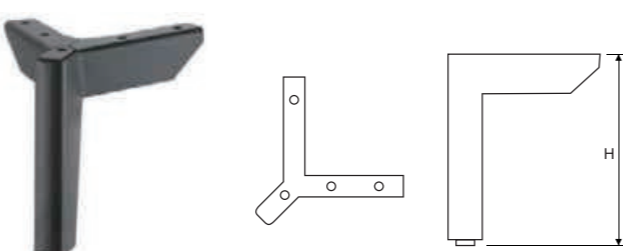

Description/描述: Sofa Leg 沙发脚  
 Material/材质: Iron 铁  
 Size/尺寸: H-80/100/120/150mm  
 Finish/表面处理: 枪黑、金色、哑黑、光铬  
 Gun black/Golden/Matt black/Chrome





# ABS ADJUSTABLE SOFA LEGS

ABS可调节沙发脚

## B1037~38

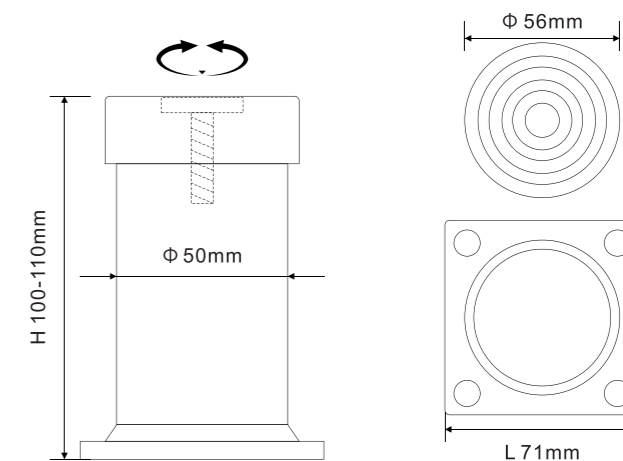

Description/描述: ABS Adjustable Soft Leg ABS可调沙发脚  
 Material/材质: ABS plastic ABS塑料  
 Size/尺寸: H-100-110mm  
 Finish/表面处理: Spray paint 喷漆  
 Colour/颜色:

## B1037~38

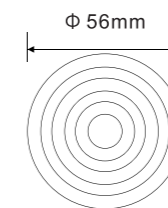
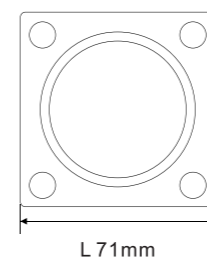
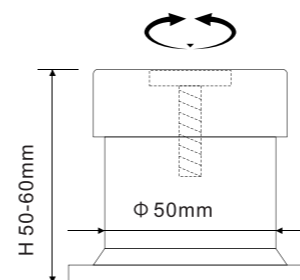

Description/描述: ABS Adjustable Soft Leg ABS可调沙发脚  
 Material/材质: ABS plastic ABS塑料  
 Size/尺寸: H-50-60mm  
 Finish/表面处理: Spray paint 喷漆  
 Colour/颜色:





SOFA FRAME SERIES  
沙发架系列



**B1037~38**

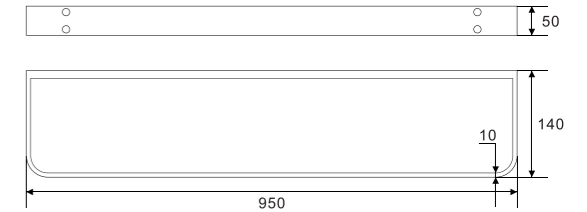

Description/描述: Stainless steel Sofa frame 不锈钢沙发架  
 Material/材质: Stainless steel 不锈钢  
 Size/尺寸: H-140mm  
 Finish/表面处理: 亮光 Polished

**B1037~38**

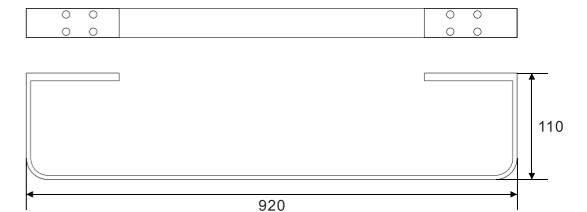

Description/描述: Stainless steel Sofa frame 不锈钢沙发架  
 Material/材质: Stainless steel 不锈钢  
 Size/尺寸: H-110mm  
 Finish/表面处理: 亮光 Polished

**B1037~38**

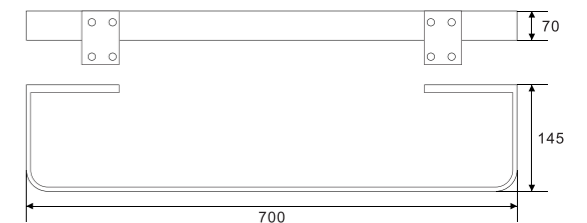

Description/描述: Stainless steel Sofa frame 不锈钢沙发架  
 Material/材质: Stainless steel 不锈钢  
 Size/尺寸: H-145mm  
 Finish/表面处理: 亮光 Polished



B1037~38

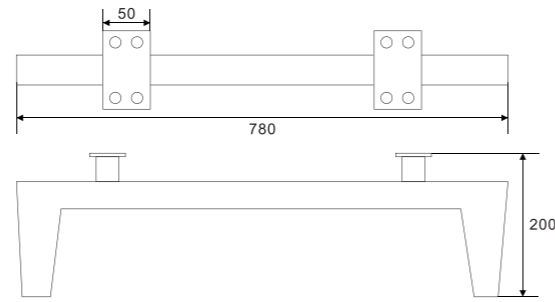
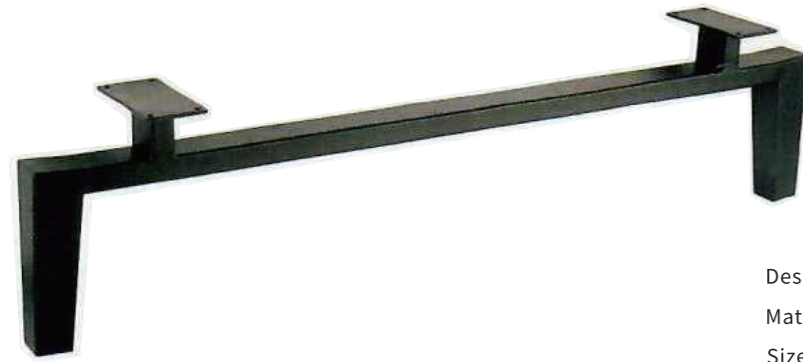

Description/描述: Steel Sofa frame 钢制沙发架  
 Material/材质: Iron 铁  
 Size/尺寸: H-200mm  
 Finish/表面处理: 喷涂  
 Spray paint

B1037~38

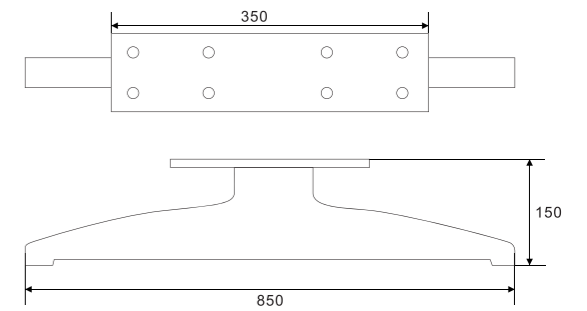

Description/描述: Steel Sofa frame 钢制沙发架  
 Material/材质: Iron 铁  
 Size/尺寸: H-150mm  
 Finish/表面处理: 喷涂  
 Spray paint

B1037~38

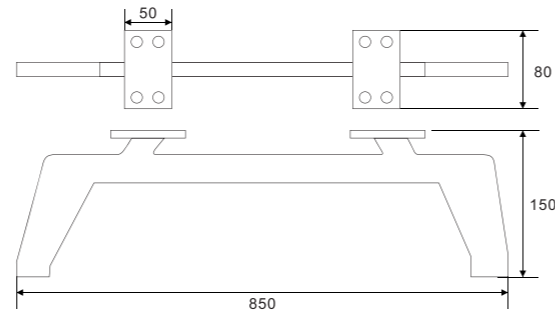

Description/描述: Steel Sofa frame 钢制沙发架  
 Material/材质: Iron 铁  
 Size/尺寸: H-150mm  
 Finish/表面处理: 喷涂  
 Spray paint

B1037~38

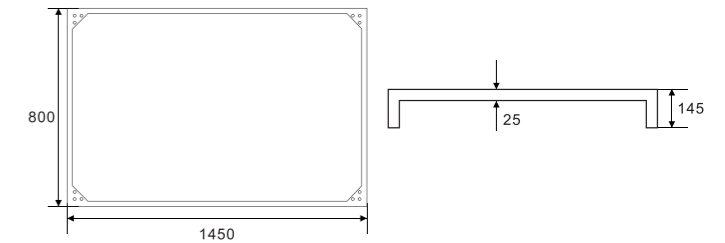

Description/描述: Stainless steel Sofa frame 不锈钢沙发架  
 Material/材质: Stainless steel 不锈钢  
 Size/尺寸: H-145mm  
 Finish/表面处理: 亮光  
 Polished

B1037~38

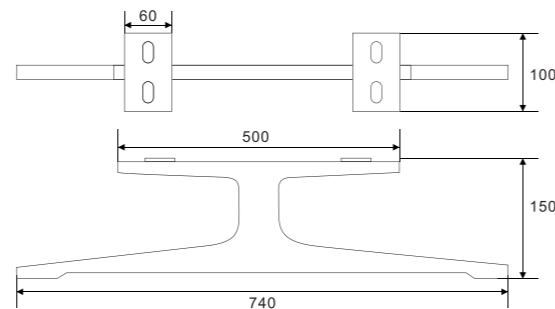

Description/描述: Steel Sofa frame 钢制沙发架  
 Material/材质: Iron 铁  
 Size/尺寸: H-150mm  
 Finish/表面处理: 喷涂  
 Spray paint

B1037~38

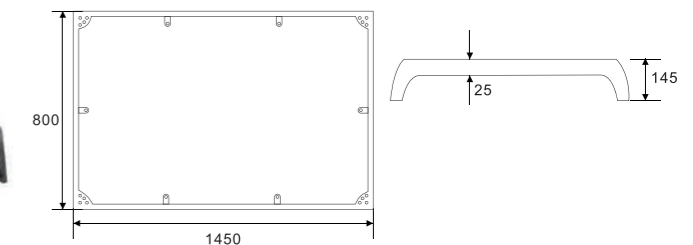

Description/描述: Stainless steel Sofa frame 不锈钢沙发架  
 Material/材质: Stainless steel 不锈钢  
 Size/尺寸: H-145mm  
 Finish/表面处理: 亮光、钛金  
 Polished\Chrome

SOFA ACCESSORIES SERIES  
沙发配件系列



**B1037~38**

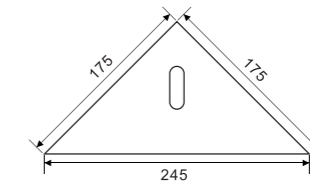

Description/描述:  
Material/材质:  
Size/尺寸:  
Finish/表面处理:

Grand triangle angle code 大三角角码  
Iron 铁  
175×175×245mm  
Bright white\亮白

**B1037~38**

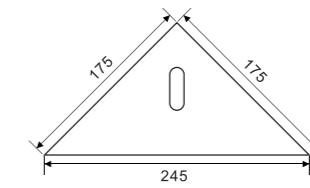

Description/描述:  
Material/材质:  
Size/尺寸:  
Finish/表面处理:

Grand triangle angle code 大三角角码  
Iron 铁  
175×175×245mm  
Golden\金色

**B1037~38**

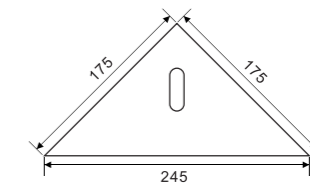

Description/描述:  
Material/材质:  
Size/尺寸:  
Finish/表面处理:

Grand triangle angle code 大三角角码  
Iron 铁  
175×175×245mm  
SK Gold\SK金

**B1037~38**

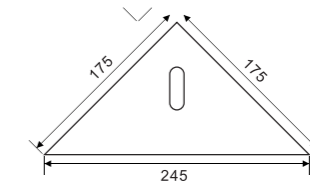

Description/描述:  
Material/材质:  
Size/尺寸:  
Finish/表面处理:

Grand triangle angle code 大三角角码  
Iron 铁  
175×175×245mm  
Sand black\砂黑



**B1037~38**

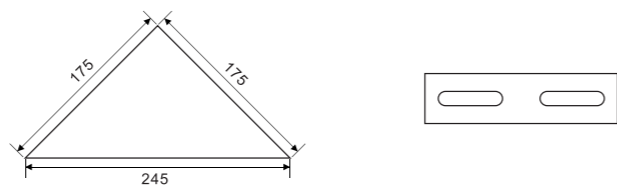

Description/描述: Figure 8 opening Corner code 8字开口角码  
 Material/材质: Iron 铁  
 Size/尺寸: 50×50×75mm  
 Finish/表面处理: SK Gold\SK金

**B1037~38**

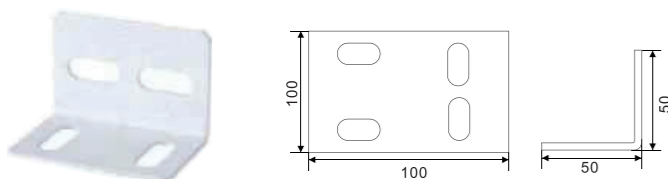

Description/描述: 8×10角码T字型A款  
 8×10 Corner code T-shaped Model A  
 Material/材质: Iron 铁  
 Size/尺寸: H-50×50×75mm  
 Finish/表面处理: Bright White\亮白

**B1037~38**

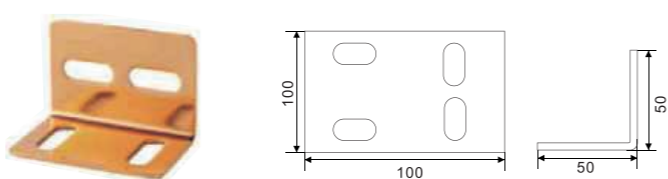

Description/描述: 8×10角码T字型A款  
 8×10 Corner code T-shaped Model A  
 Material/材质: Iron 铁  
 Size/尺寸: H-50×50×75mm  
 Finish/表面处理: SK Gold\SK金

**B1037~38**

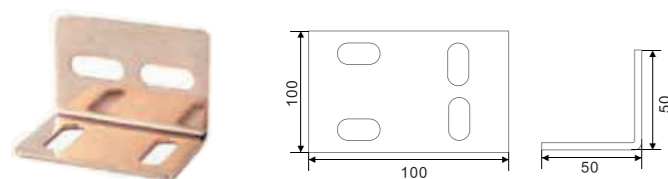

Description/描述: 8×10角码T字型A款  
 8×10 Corner code T-shaped Model A  
 Material/材质: Iron 铁  
 Size/尺寸: H-50×50×75mm  
 Finish/表面处理: Light K Gold\浅K金

**B1037~38**

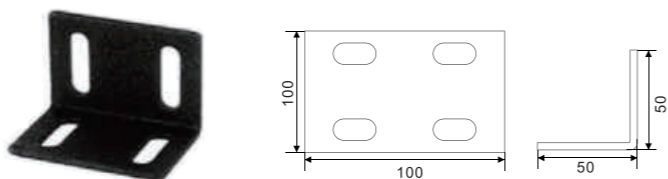

Description/描述: 8×10角码双横型A款  
 8×10 Corner code double horizontal Model A  
 Material/材质: Iron 铁  
 Size/尺寸: H-50×50×75mm  
 Finish/表面处理: Brown Skin Texture\棕色皮纹

**B1037~38**

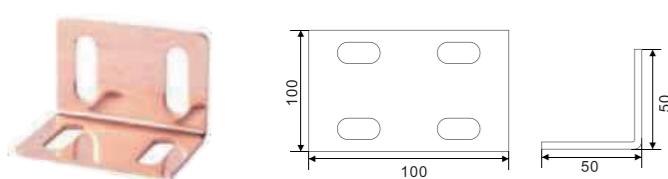

Description/描述: 8×10角码双横型A款  
 8×10 Corner code double horizontal Model A  
 Material/材质: Iron 铁  
 Size/尺寸: H-50×50×75mm  
 Finish/表面处理: Rose Gold\玫瑰金

**B1037~38**

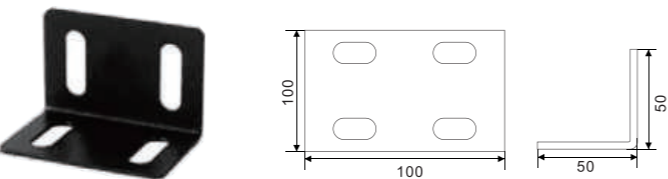

Description/描述: 8×10角码双横型A款  
 8×10 Corner code double horizontal Model A  
 Material/材质: Iron 铁  
 Size/尺寸: H-50×50×75mm  
 Finish/表面处理: Sand Black\砂黑

**B1037~38**

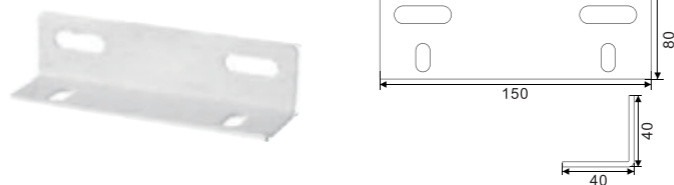

Description/描述: 8×15角码T字型A款  
 8×15 Corner code T-shaped Model A  
 Material/材质: Iron 铁  
 Size/尺寸: 40×40×150mm  
 Finish/表面处理: Bright White\亮白

**B1037~38**

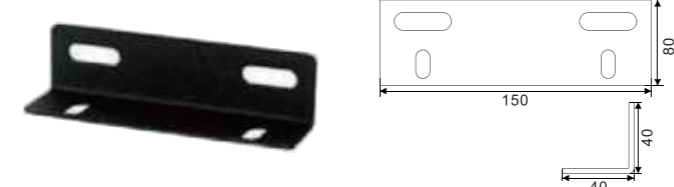

Description/描述: 8×15角码T字型A款  
 8×15 Corner code T-shaped Model A  
 Material/材质: Iron 铁  
 Size/尺寸: 40×40×150mm  
 Finish/表面处理: Sand black\砂黑

**B1037~38**

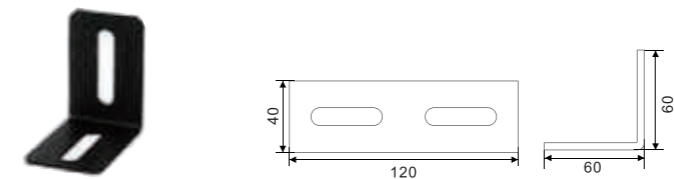

Description/描述: 7字角码  
 7-Word Corner code  
 Material/材质: Iron 铁  
 Size/尺寸: 60×60×40mm  
 Finish/表面处理: Sand black\砂黑

**B1037~38**



Description/描述: Articulator solid thread 关节器实心螺牙  
 Material/材质: Iron 铁  
 Size/尺寸: H-40/50/60/70/90mm  
 Finish/表面处理: Chrome\镀铬

**B1037~38**

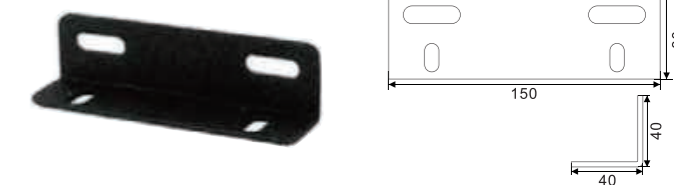

Description/描述: 8×15角码T字型A款  
 8×15 Corner code T-shaped Model A  
 Material/材质: Iron 铁  
 Size/尺寸: 40×40×150mm  
 Finish/表面处理: Brown Skin Texture\棕色皮纹

**B1037~38**

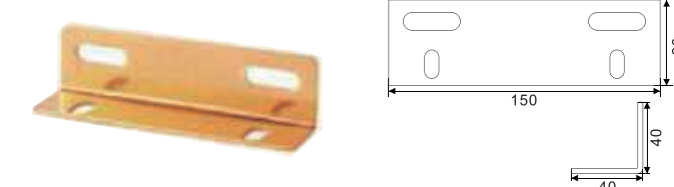

Description/描述: 8×15角码T字型A款  
 8×15 Corner code T-shaped Model A  
 Material/材质: Iron 铁  
 Size/尺寸: 40×40×150mm  
 Finish/表面处理: SK Gold\SK金

**B1037~38**

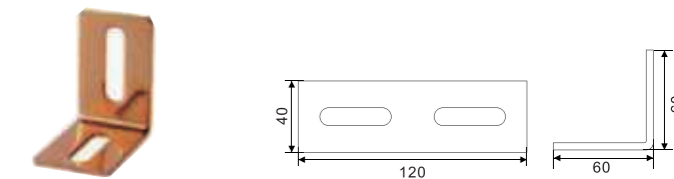

Description/描述: 7字角码  
 7-Word Corner code  
 Material/材质: Iron 铁  
 Size/尺寸: 60×60×40mm  
 Finish/表面处理: SK Gold\SK金

**B1037~38**



Description/描述: Articulator with sleeve 关节器带套筒  
 Material/材质: Iron 铁  
 Size/尺寸: H-105/110/115/120/125/135/150mm  
 Finish/表面处理: Chrome\镀铬

**B1037~38**

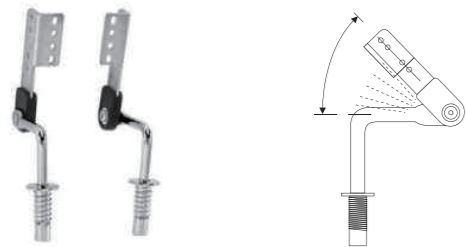

Description/描述: Articulator with sleeve 关节器带套筒  
 Material/材质: Iron 铁  
 Size/尺寸: Angle:90-190°  
 Block:6/8/10  
 Finish/表面处理: Chrome\镀铬

**B1037~38**

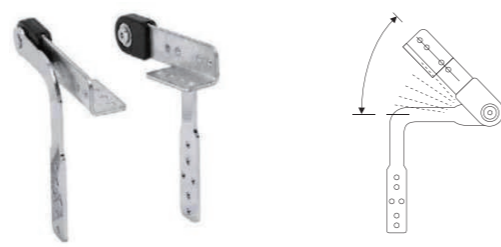

Description/描述: Articulator 关节器  
 Material/材质: Iron 铁  
 Size/尺寸: Angle:90-180°/90-190°  
 Block:6/8/10  
 Finish/表面处理: Chrome\镀铬

**B1037~38**

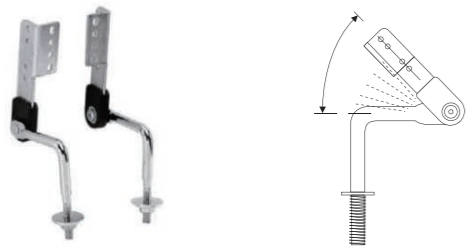

Description/描述: Articulator 关节器  
 Material/材质: Iron 铁  
 Size/尺寸: Angle:90-190°  
 Block:6/8/10  
 Finish/表面处理: Chrome\镀铬

**B1037~38**

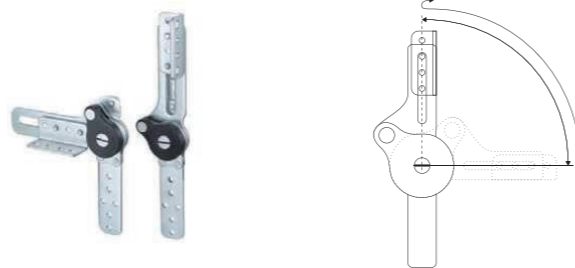

Description/描述: Steel Support Sofa Foot 反弹小平铰带升降角码  
 Material/材质: Iron 铁  
 Size/尺寸: Angle:90-190°/90-180°/105-190°  
 Block:3/4/5/6  
 Finish/表面处理: Chrome\镀铬

**B1037~38**

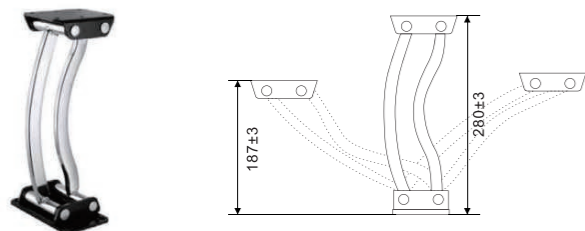

Description/描述: Manual backrest forward 手动靠背前移  
 Material/材质: Iron 铁  
 Size/尺寸: H-280mm  
 Finish/表面处理: Chrome\镀铬

**B1037~38**

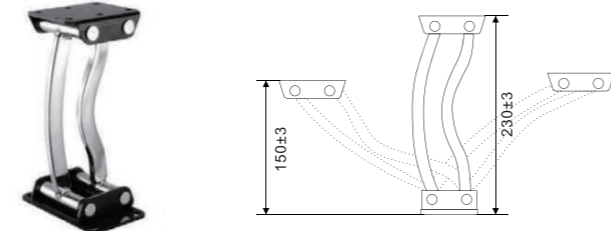

Description/描述: Manual backrest forward 手动靠背前移  
 Material/材质: Iron 铁  
 Size/尺寸: H-230mm  
 Finish/表面处理: Chrome\镀铬

**B1037~38**



Description/描述: 12 points straight pin  
 Material/材质: Iron 铁  
 Size/尺寸: 120mm  
 Finish/表面处理: White zinc\白锌

**B1037~38**



Description/描述: 四人份接头 Connector  
 Material/材质: Iron 铁  
 Size/尺寸: 70mm  
 Finish/表面处理: Chrome\镀铬

**B1037~38**



Description/描述: 沙发扣 Sofa buckle  
 Material/材质: Iron 铁  
 Size/尺寸:  
 Finish/表面处理: White zinc\白锌

**B1037~38**



Description/描述: 沙发扣 Sofa buckle  
 Material/材质: Iron 铁  
 Size/尺寸: 110/90/75mm  
 Finish/表面处理: Chrome\镀铬

**B1037~38**



Description/描述:  
 Material/材质:  
 Size/尺寸:  
 Finish/表面处理:

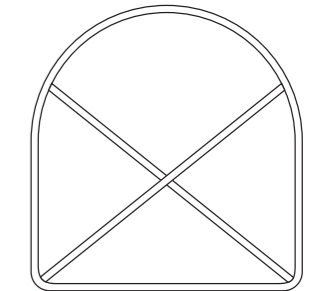

Leisure chair frame 休闲椅架  
 Stainless steel 不锈钢  
 mm  
 哑黑/Matt black

**B1037~38**



Description/描述:  
 Material/材质:  
 Size/尺寸:  
 Finish/表面处理:

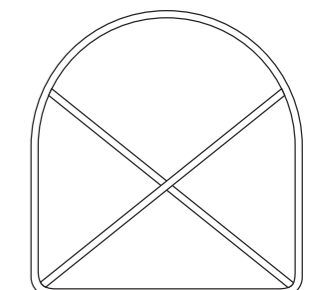

Leisure chair frame 休闲椅架  
 Stainless steel 不锈钢  
 mm  
 哑黑/Matt black



# SIMPLE FOLDING TABLE SERIES

## 简易折叠桌系列

STRONG  
ELEGANT  
STAND ALONE



## ◎ SIMPLE FOLDING TABLE SERIES | 简易折叠桌系列

B1037~38



**牢固的固定夹**  
Strong Retaining Clips



**易安装**  
Easy To Assemble



**增强稳定性**  
Reinforced Stability



**轻松易折叠**  
Easily Folding



**没有尖角**  
No Sharp Corners



**防护脚垫**  
Protective Foot Pads



体积 Volume	重量 Weight	测量 Measurements 宽度-长度-高度 Width - Length - Height	20集装箱容量 20 Dc Container Capacity	40集装箱容量 40 Dc Container Capacity
0.014688	3,333 kg	36×48×65cm 14,2×18,9×25,6 inch	2. 180	5. 000

## Colors



Bendir



Kudüm



Somono



White



B1037~38

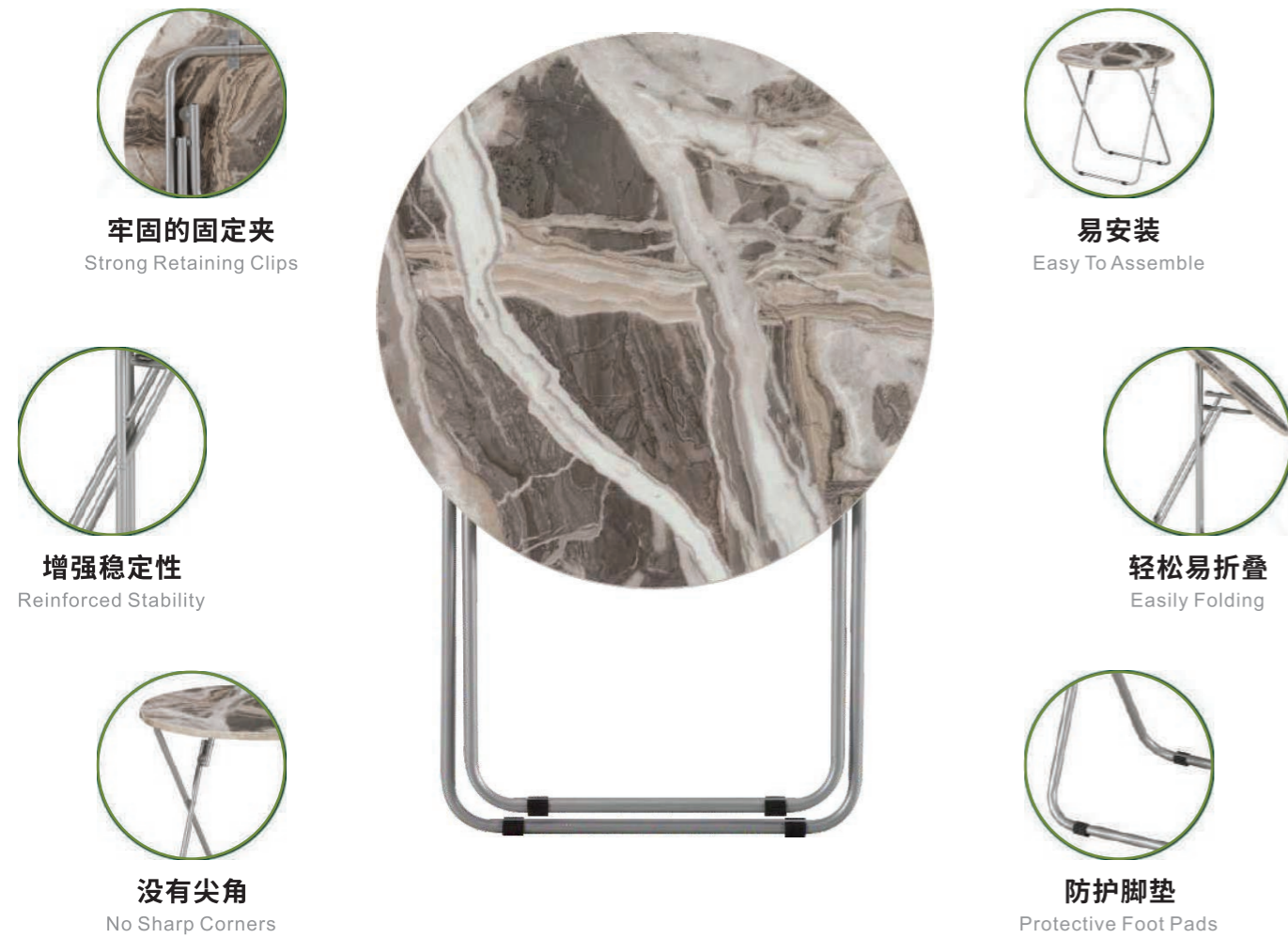

体积 Volume	重量 Weight	测量 Measurements 宽度-长度-高度 Width - Length - Height	20集装箱容量 20 Dc Container Capacity	40集装箱容量 40 Dc Container Capacity
0.02233	4,6 kg	60×65cm 23.6×25,6 inch	1.440	3.380

## Colors



Seed series is practical, suitable for any environment, minimal and comfortable with its low structure and small table width.

B1037~38

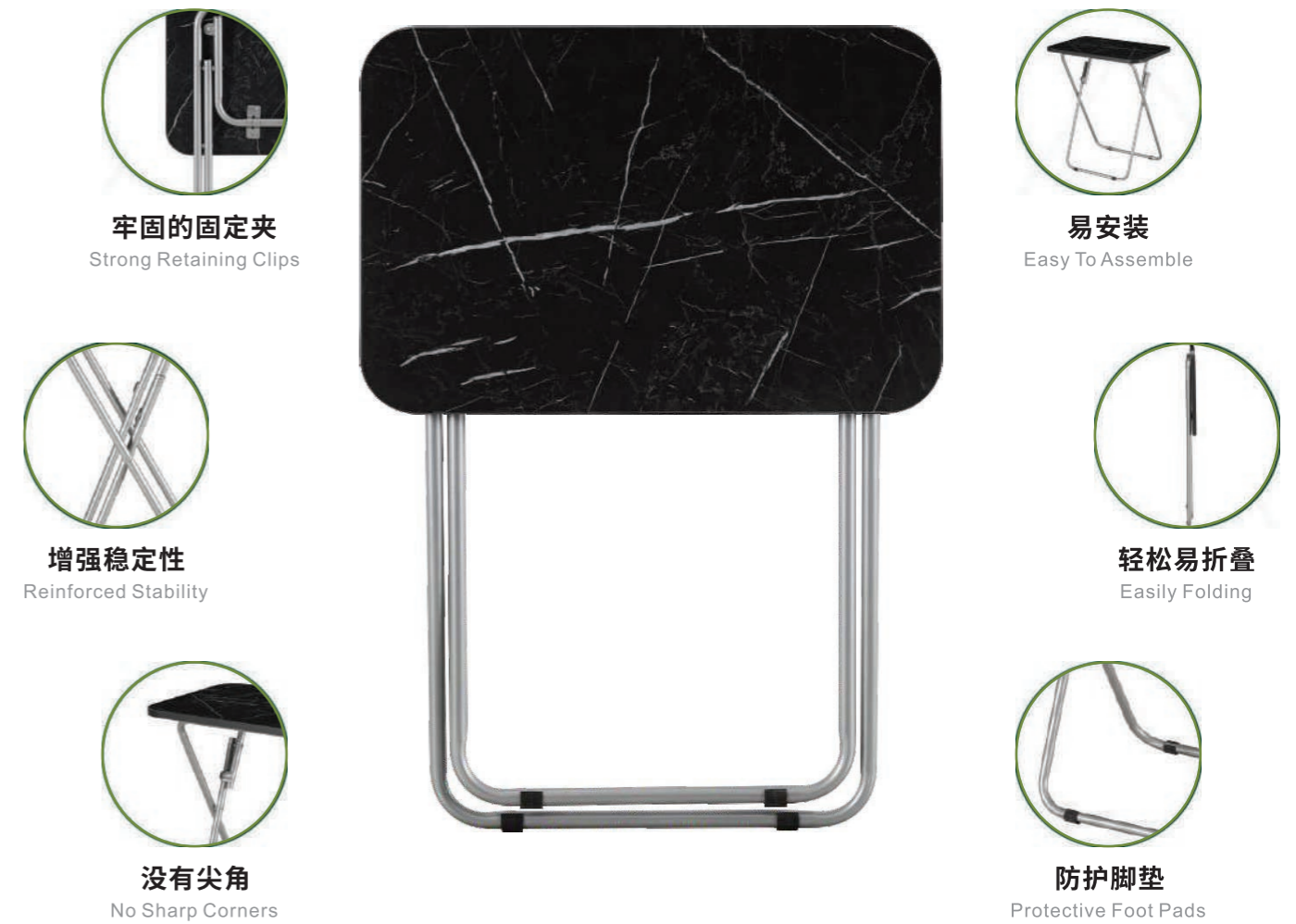

体积 Volume	重量 Weight	测量 Measurements 宽度-长度-高度 Width - Length - Height	20集装箱容量 20 Dc Container Capacity	40集装箱容量 40 Dc Container Capacity
0.02	4,85 kg	40×60×72cm 15,7×23,6×28,3 inch	1.620	3.780
0.03	7,00 kg	50×70×72cm 19,7×27,5×28,3 inch	1.070	2.500
0.03048	7,00 kg	70cm - 27,5 inch Round Table	1.040	2.450

## Colors

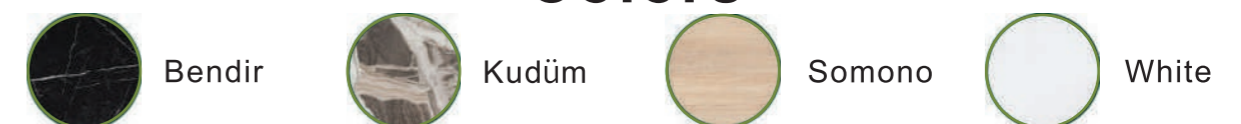

The Flower series is suitable as a computer desk or snack table with its medium height leg structure and medium table width.